

FOR LEASE | STUDIO OFFICE | SOUTH BUILDING

35 GOLDEN AVENUE

TORONTO | ON



METROPOLITAN
COMMERCIAL





DETAILS

Location	Top of Golden Avenue near Dundas St W and Bloor St W. Click Here for Map
Building Details	Unit 106 - 2,025 SF
Rental Rate	Unit 106 - \$7,256.00/Month
Term	1-3 years
Possession	June 1, 2025
Parking	Limited onsite parking space - \$79/Month

FEATURES

- Studio office space multi office but can open up plan
- Main floor with polished concrete floors and 14ft ceilings
- Steps to Dundas West TTC subway station.
- Abundant natural light
- Wheelchair access

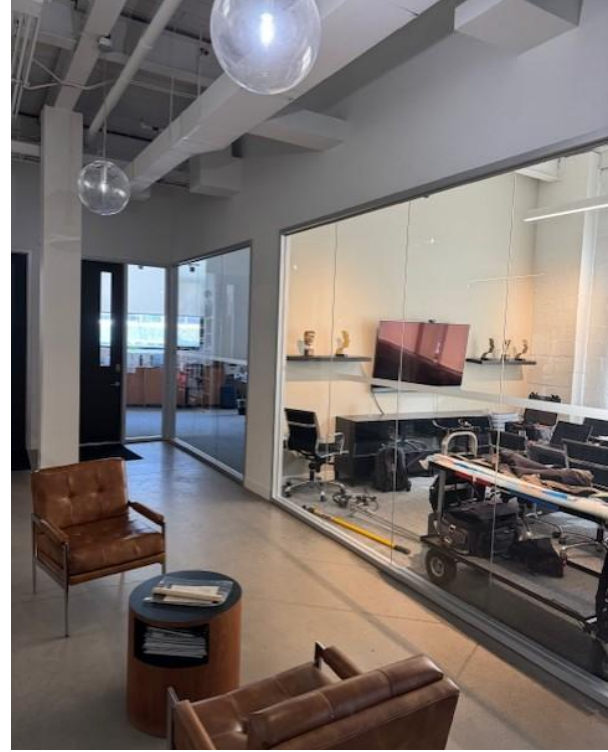

BUILDING PHOTOS

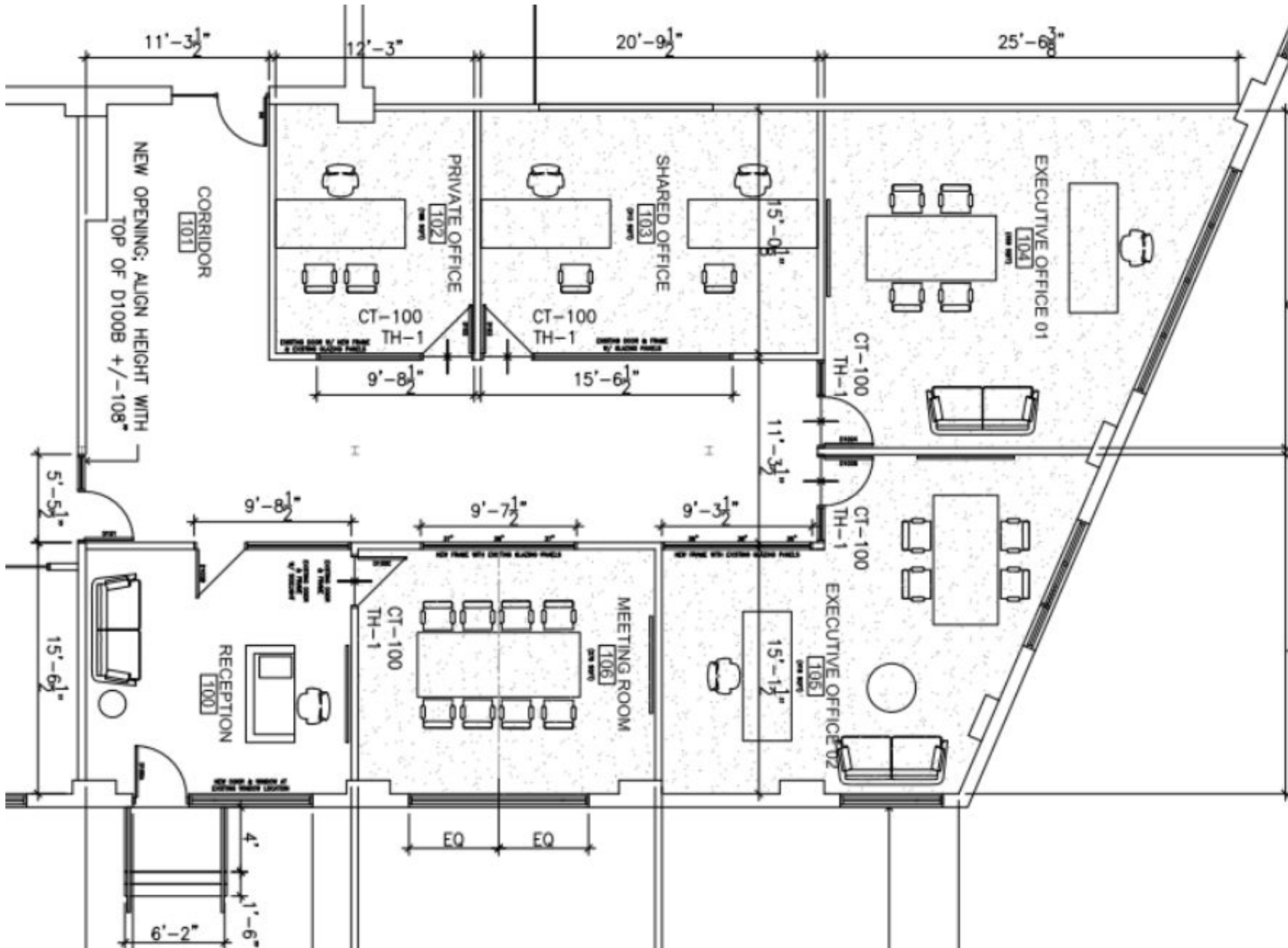

FLOOR PLAN

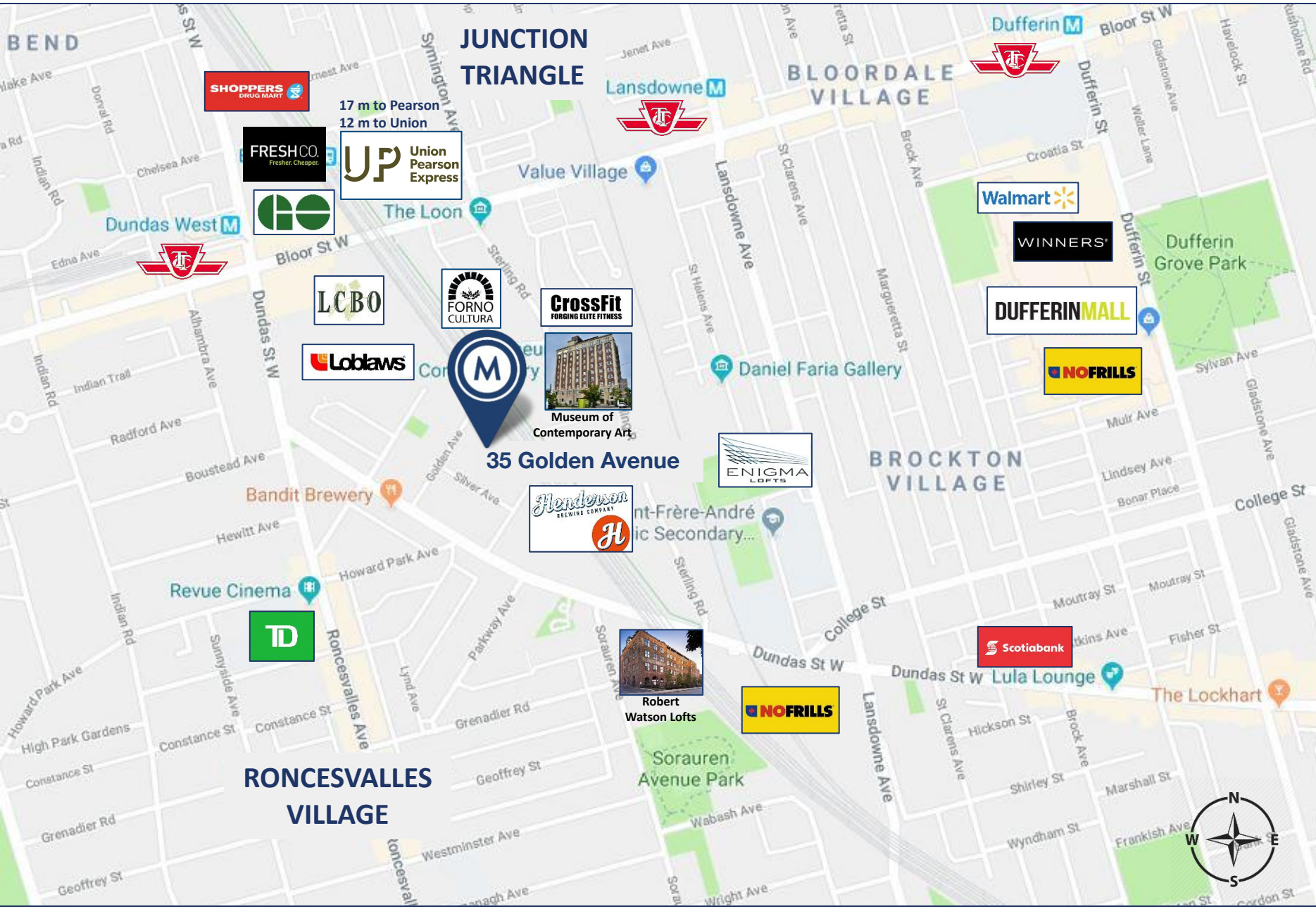

AREA MAP

35 GOLDEN AVENUE | FOR LEASE



METROPOLITAN COMMERCIAL

150 Beverley Street, Unit 1
Toronto, ON
M5T 1Y5

www.metcomrealty.com

CONTACT:

TIM NOVAK*
Senior Vice President
416.703.6621 ext. 246
tim.novak@metcomrealty.com